

Resort Facilities

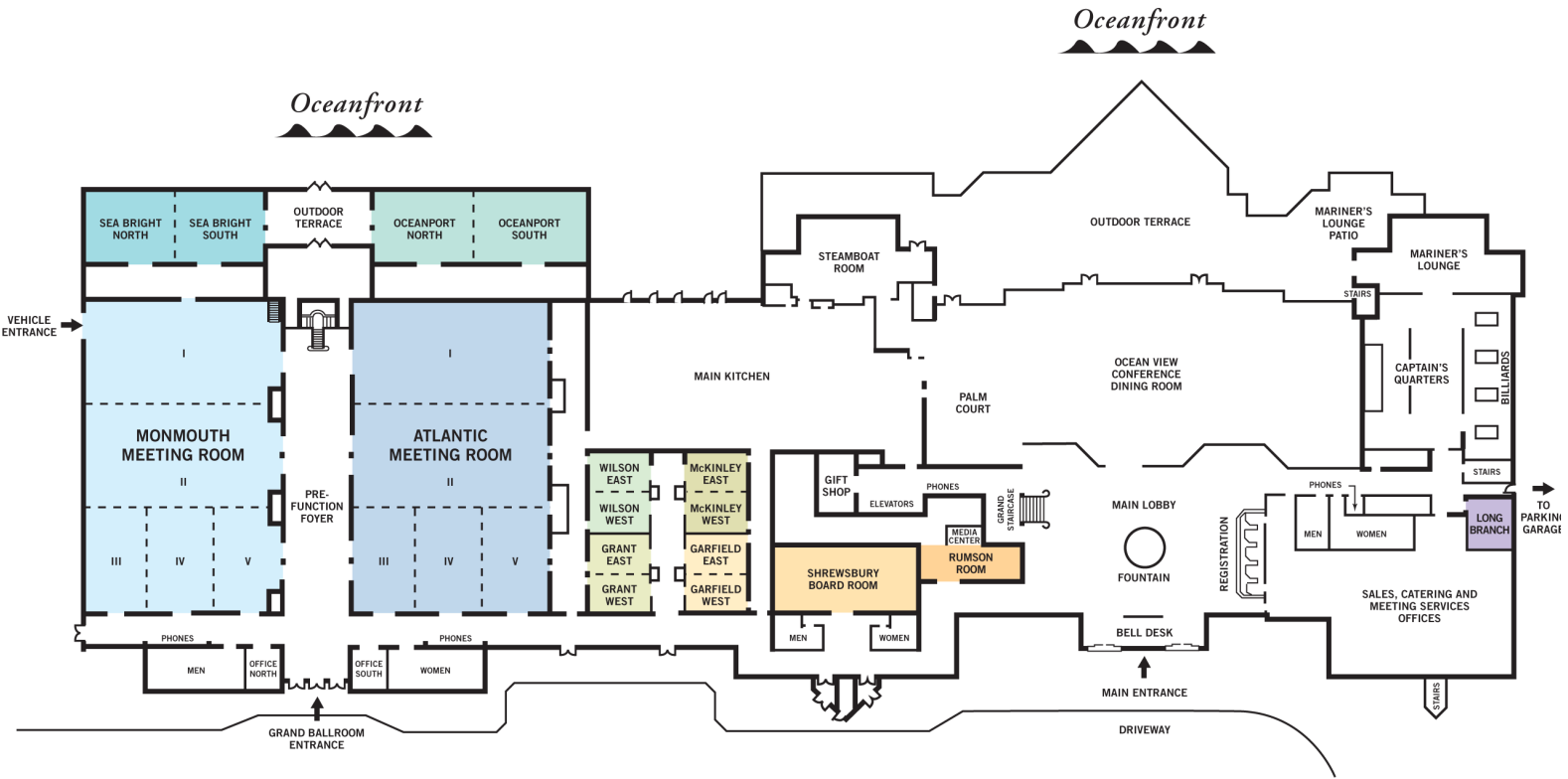

First Floor

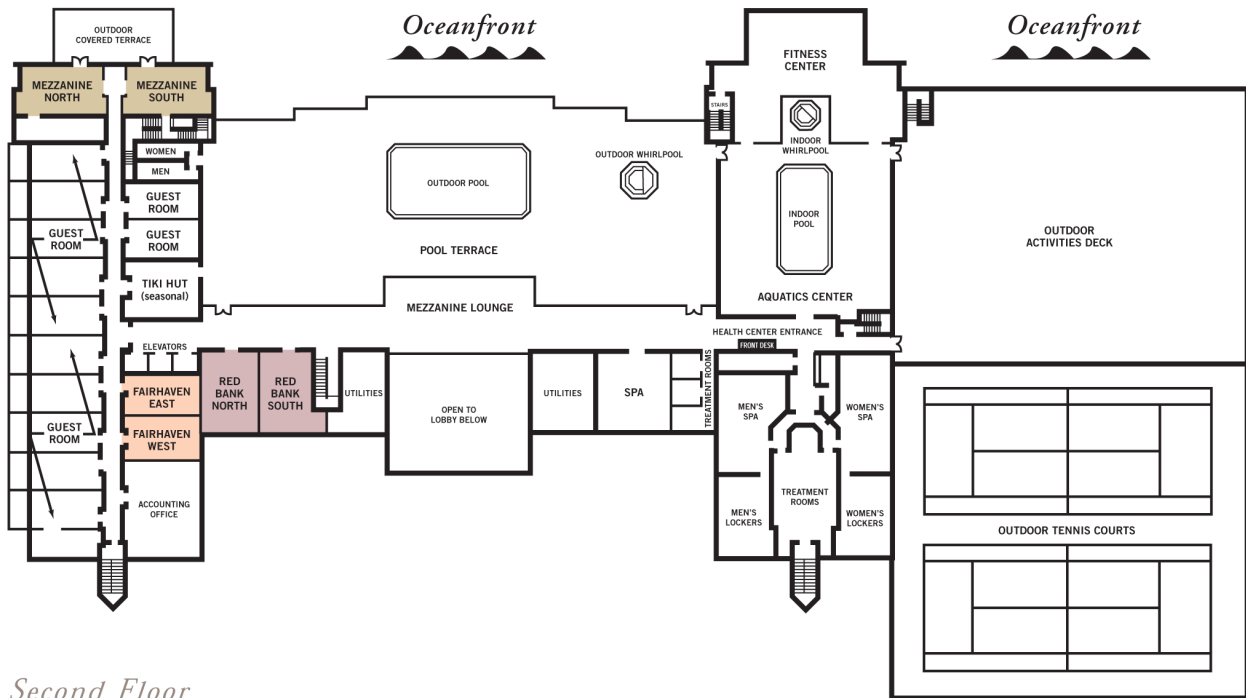

Second Floor

Meeting Room Capacities

<i>Conference Room Description</i>			<i>Conference Room Capacities</i>				
ROOM NAME	DIMENSION	AREA IN SQ. FEET	THEATRE	CLASSROOM	BANQUET	CONFERENCE	U-SHAPE
Atlantic Meeting Room	128' x 79'	10,300	1,000	600	800	N/A	N/A
Atlantic I	42' x 79'	3,318	340	200	250	N/A	N/A
Atlantic II	42' x 79'	3,318	340	200	250	N/A	N/A
Atlantic III	26' x 42'	1,092	120	60	100	40	30
Atlantic IV	26' x 42'	1,092	120	60	100	40	30
Atlantic V	26' x 42'	1,092	120	60	100	40	30
Monmouth Meeting Room*	128' x 79'	10,300	1,000	600	800	N/A	N/A
Monmouth I	42' x 79'	3,318	340	200	250	N/A	N/A
Monmouth II	42' x 79'	3,318	340	200	250	N/A	N/A
Monmouth III	26' x 42'	1,092	120	60	100	40	30
Monmouth IV	26' x 42'	1,092	120	60	100	40	30
Monmouth V	26' x 42'	1,092	120	60	100	40	30
Sea Bright	33' x 80'	2,640	117	92	144	42	51
Sea Bright North	33' x 40'	1,320	82	54	90	26	25
Sea Bright South	33' x 40'	1,320	82	40	56	26	23
Oceanport	33' x 94'	3,102	160	112	192	56	63
Oceanport North	33' x 40'	1,320	82	50	64	26	28
Oceanport South	33' x 54'	1,782	150	93	104	36	44
Woodrow Wilson	32' x 25'	800	60	40	50	30	20
Woodrow Wilson East	16' x 25'	400	30	20	20	15	10
Woodrow Wilson West	16' x 25'	400	30	20	20	15	10
William McKinley	32' x 25'	800	60	40	50	30	20
William McKinley East	16' x 25'	400	30	20	20	15	10
William McKinley West	16' x 25'	400	30	20	20	15	10
Ulysses S. Grant	32' x 25'	800	60	40	50	30	20
Ulysses S. Grant East	16' x 25'	400	30	20	20	15	10
Ulysses S. Grant West	16' x 25'	400	30	20	20	15	10
James A. Garfield	32' x 25'	800	60	40	50	30	20
James A. Garfield East	16' x 25'	400	30	20	20	15	10
James A. Garfield West	16' x 25'	400	30	20	20	15	10
Shrewsbury Boardroom	25' x 59'	1,475	80	60	100	30	40
Mezzanine Boardroom North	18' x 26'	468	35	20	30	20	15
Mezzanine Boardroom South	18' x 26'	468	35	20	30	20	15
Fairhaven East	13' x 18'	330	20	15	20	15	5
Fairhaven West	13' x 18'	330	20	15	20	15	5
Red Bank North	15' x 28'	420	30	20	20	15	10
Long Branch	19' x 20'	380	30	20	20	15	10
Atlantic Boardroom (not shown)	26' x 24'	624	40	20	30	15	15

Meeting rooms offer ceiling heights up to 18 feet.

* Vehicle access available.